

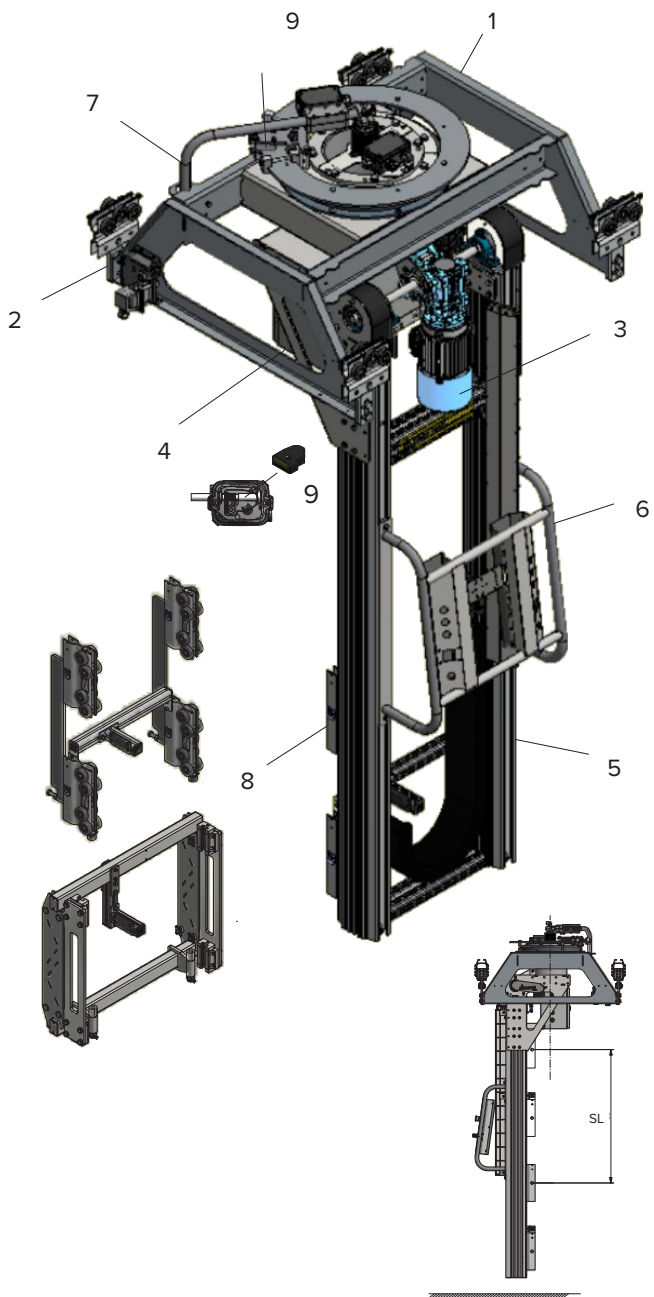

MECHSTACK PRO™

Data sheet / Datablad / Datenblatt / Fiche technique



Technical data

Tekniska data / Technische Daten / Données techniques

	Standard	Heavy Duty	
Maximum load ¹ Max. Last / Charge max.	150/250	150/250/400/650	kg
Maximum moment ² Couple max.	1500-2000	1500-4000	Nm
Maximum lifting stroke SL Max slaglängd / Max. Hüblänge / Course max.	4910	4835	mm
Rotation ³ Rotation	0-310/360	0-310/360	°
Lifting speed Lyftastighet / Hübggeschwindigkeit / Vitesse de levage	0-10	0-10	m/min
Tare weight ⁴ Egenvikt / Eigengewicht / Poids propre	222-350	255-415	kg
Motor output Motoreffekt / Motorleistung / Puissance moteur	0,75	0,75/1,5	kW
Voltage Spänning / Spannung / Tension	1x230, N, PE (±15) 50/60 Hz		V
Fuse Säkring / Sicherung / Pré-freinage		10	AT
Enclosure class Kapslingsklass / Schutzklasse / Indice de protection		54	IP
Work temperature Arb.temperatur / Betriebstemperatur / Temp. de régime		5-40	°C
Noise level Bullernivå / Schallpegel / Niveau sonore		<70	dB (A)

¹ Depends on engine unit
² Depends on lifting stroke SL
³ Depends on media connection
⁴ Depends on configuration

- | | | | |
|-----------------------|-----------------|----------------------|---------------------|
| 1. Cross unit | Kryssenhet | Deckenwagen | Unité de crois |
| 2. Suspensions | Nedpendling | Aufhängung | Suspension |
| 3. Engine unit | Motorenhet | Motoreinheit | Unité de moteur |
| 4. Electric cabinet | Elskåp | Schaltschrank | Coffret électrique |
| 5. Pillar unit | Pelarenhet | Hebesäule | Unité de pilier |
| 6. Operator handle | Manöverhandtag | Bedienungsoberfläche | Panneau de commande |
| 7. Media connection | Mediaanslutning | Medienanschluss | Raccord de média |
| 8. Tool carrier frame | Verkttygsslåde | Werkzeugeramen | Cadre d'outil |
| 9. Encoder | Enkoder | Enkoder | Encodeur |

Mechstack Pro STD Standard

Max moment (Nm)	1 000	1 500	2 000
Max load kg	150/250	150/250	150/250
Max Z mm	5 945	5 200	4 010
Max stroke SL mm	4 910	4 165	2 975

1035 < Z < 5945

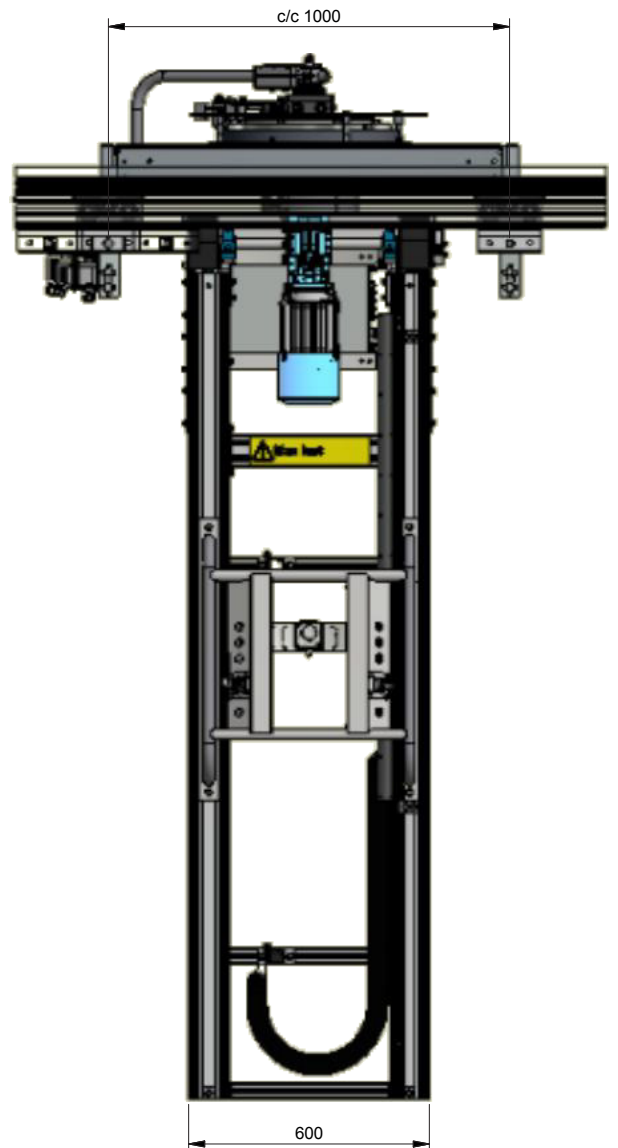
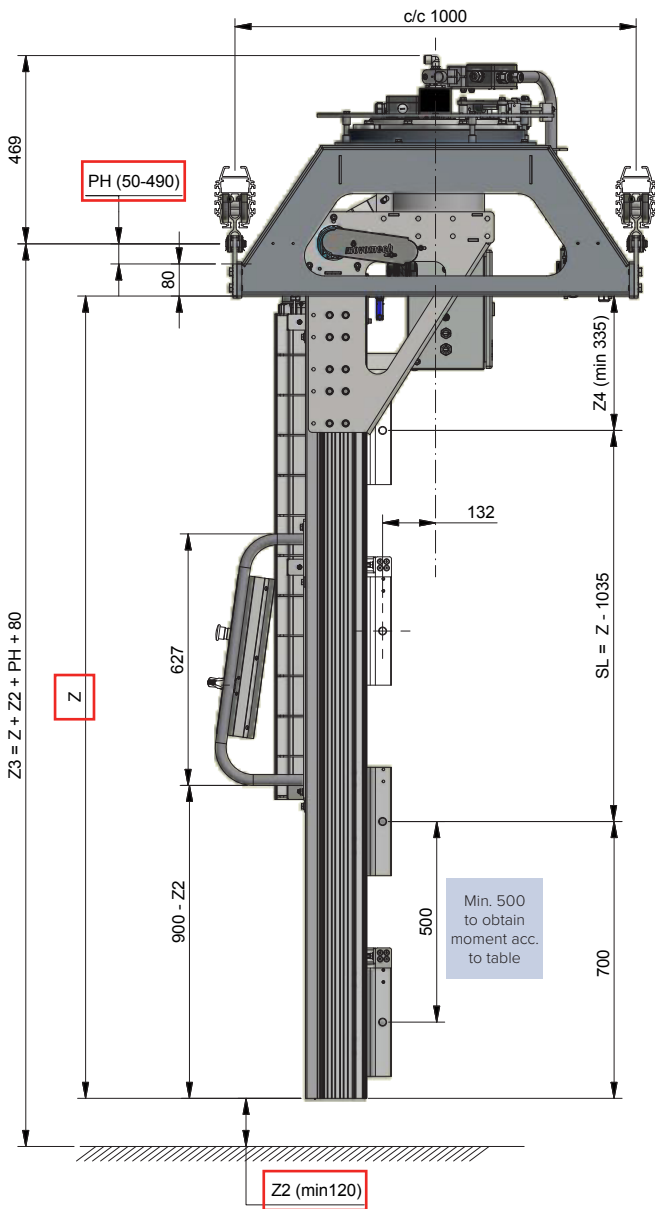

Mechstack Pro HD Heavy Duty

Max moment (Nm)	1 000	1 500	2 000	2 500	3 000	3 500	4 000
Max load kg	150/250/400/650						
Max Z mm	5 945	4 590	3 590	2 990	2 590	2 290	2 090
Max stroke SL mm	4 835	3 480	2 480	1 880	1 480	1 180	980

1110 < Z < 5945

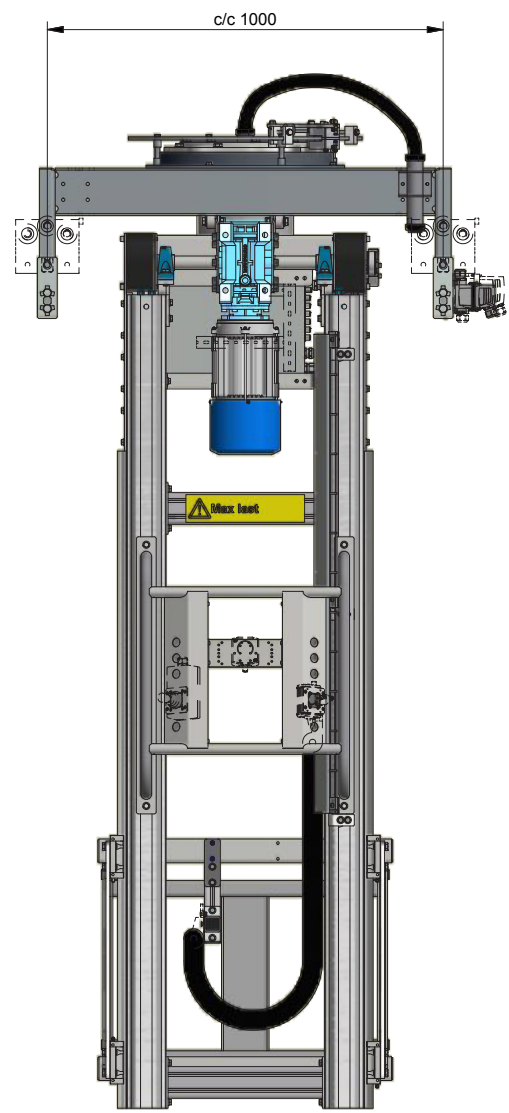
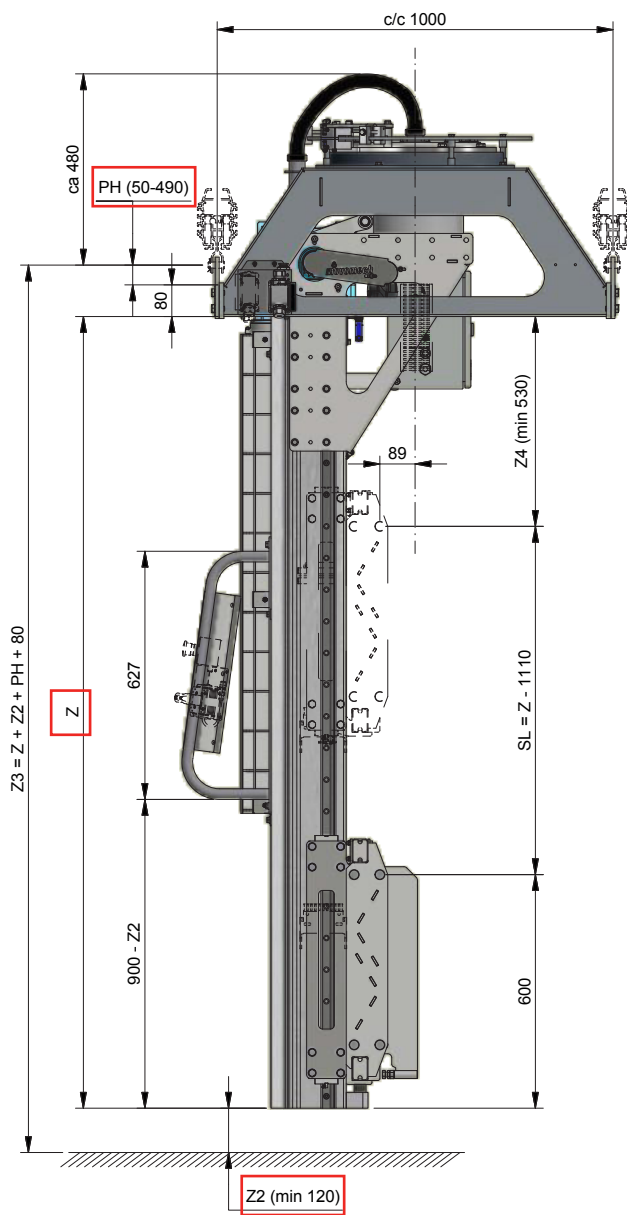

Mechstack Pro STD Standard
Mechstack Pro HD Heavy Duty

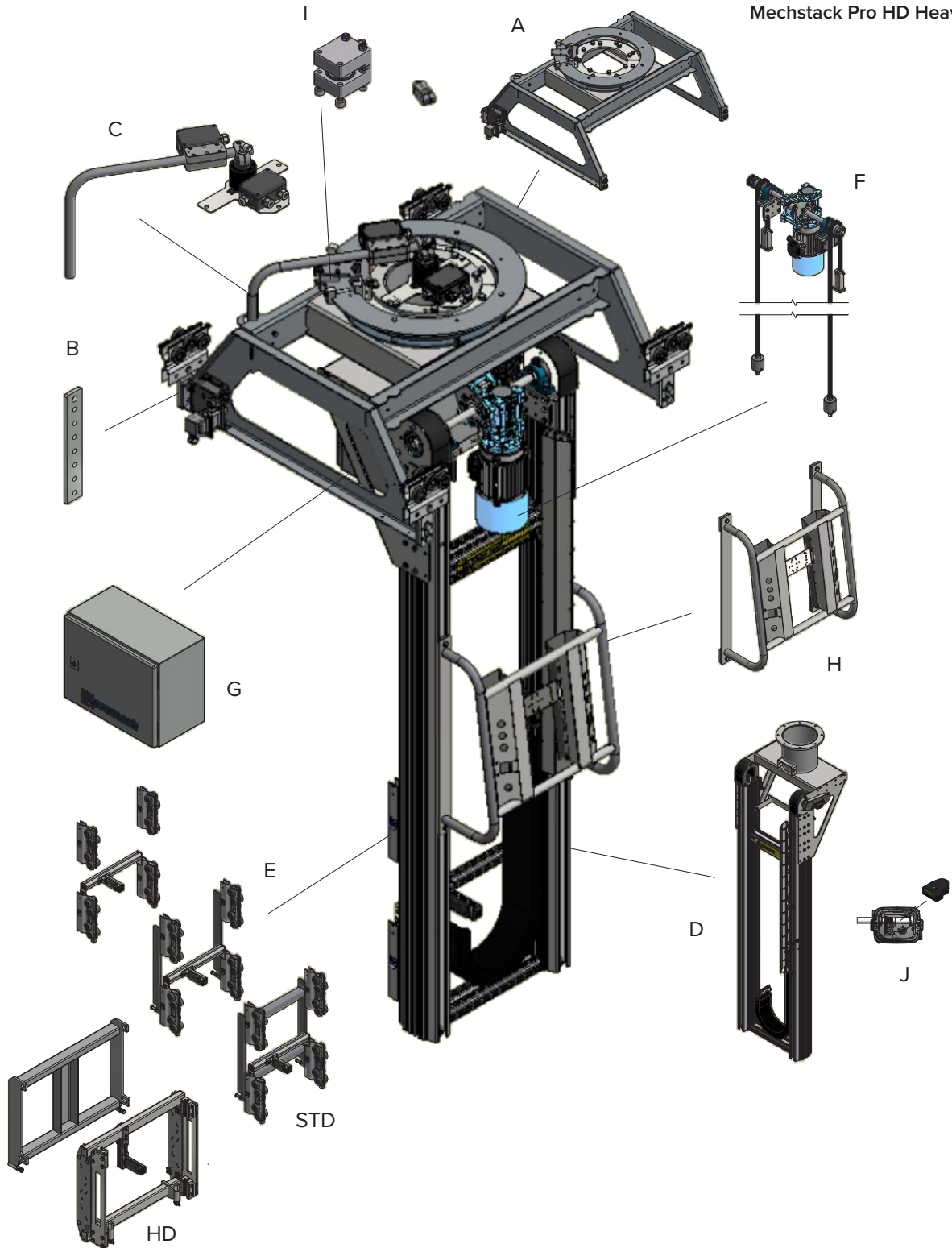



	Configuration	PH (mm)	Order quantity:	kg		
B	PH 50	50	4	0,6	733835	733837
	PH 90-210	90-130-170-210 *	4	1,1	740940	740941
	PH 250-370	250-290-330-370 *	1	<11	740943	740945
	PH 410-490	410-450-490 *	1	<13	740947	740949
				Ø (mm)	16,5	20,5
				Fits trolley	AHB1.1-2	AHB3

* Cut to selected suspension height PH

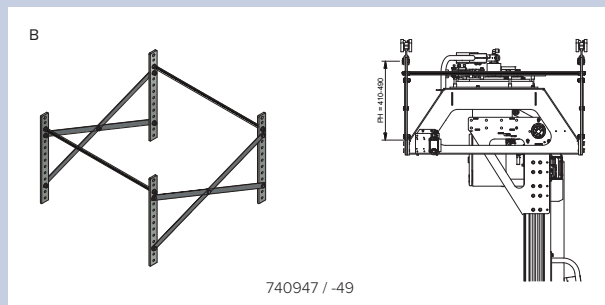
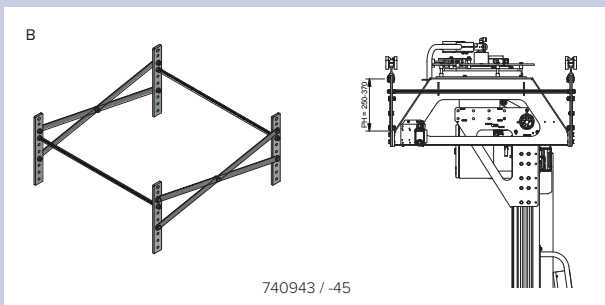
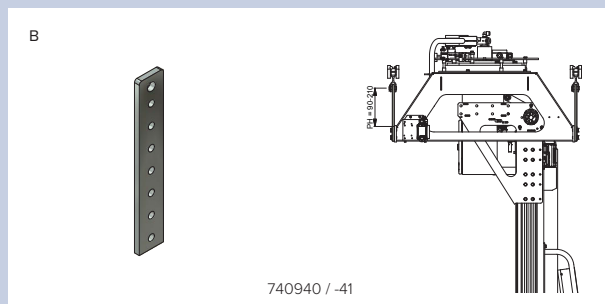
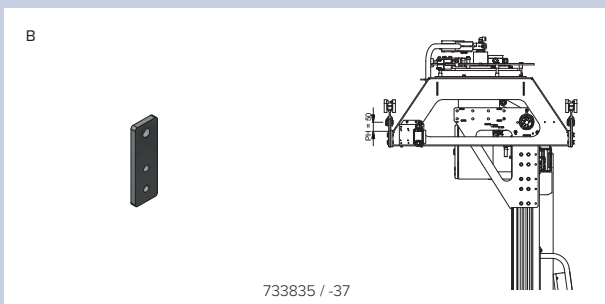

	Media connection	Rotation	kg		
C	Standard	0-310°	1,2	743291	
	6 pol	0-360° free	6,2	743292	
	6 pol 2 pneu	0-360° free	6,6	743293	
	6+12 pol	0-360° free	7,0	743294	
	6+12 pol 2 pneu	0-360° free	7,4	743295	

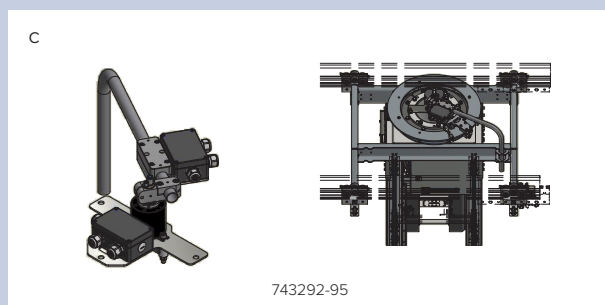
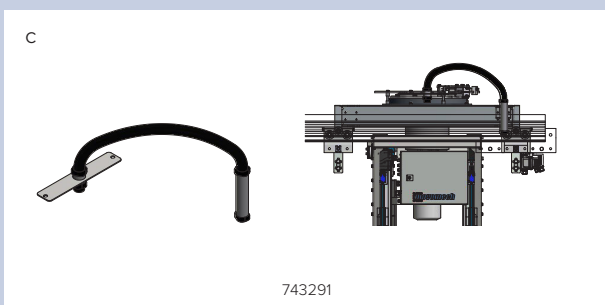

D (STD) STD: Standard

70-157 kg
70+17,6*(Z-1035)/1000 kg

743282

E (STD)

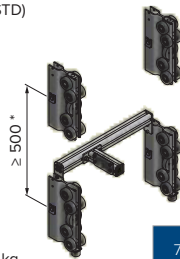

8,5 kg

743288

E (STD)

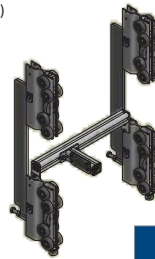

16 kg

743289

E (STD)

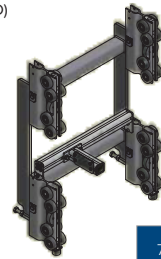

22 kg

743290

* ≥ 500 mm for full moment

D (HD) HD: Heavy Duty

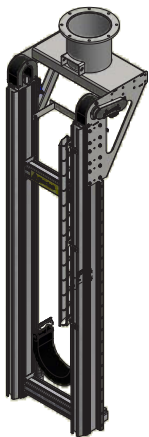
77-170 kg
77+19,2*(Z-1110)/1000 kg

743281

E (HD)

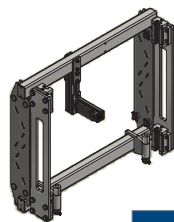

34 kg

743287

E (HD)

Option:
Weldable (add-on) tool frame
Svetsbar (påmonterad) verktygsram
Schweißbar Rahmen (Erweiterung)
Cadre soudable (supplémentaire)

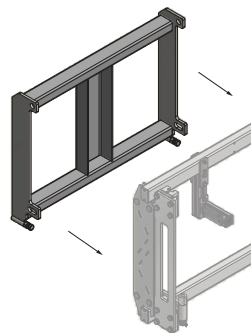

18 kg

743297

F

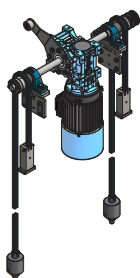

	Engine unit	For version	kW	kg	
F	Busck 150/250 kg	STD / HD	0,75	36,5	745024
	SEW 150/250 kg	STD / HD	0,75	44,5	743284
	Busck 400/650 kg	HD	1,5	55	745025
	SEW 400/650 kg	HD	1,1	68	743286

G

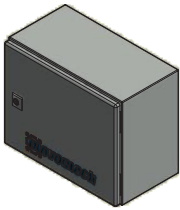

	Electric cabinet	For version	kg	
G	150 kg	STD / HD	15,5	743414
	250 kg	STD / HD	15,5	743434
	400 kg	HD	15,5	743415
	650 kg	HD	15,5	743435

I

Brake

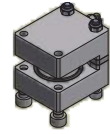

0,4 kg

742708

H

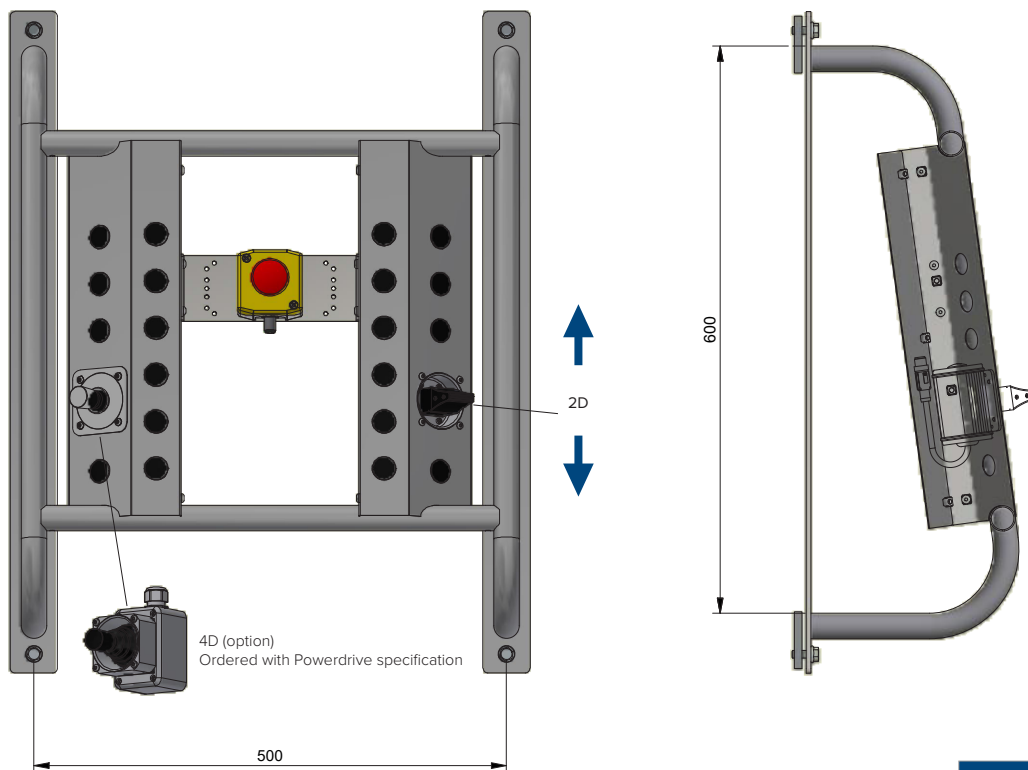

7,7 kg

744669

J

Encoder

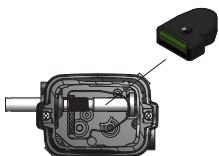

742291

Encoder

The encoder simplifies positioning in the Z direction. Mounted in the rotary limit switch. Teach-in function. Connected directly (no external PLC required).

Encodern förenklar positionering i Z-led. Monteras i spindelgränsläget. Teach-in-funktion. Kopplas direkt (ingen extern PLC nödvändig).

Der Encoder erlaubt Positionierung in der Z-Richtung. Am Getriebeendschalter montiert. Teach-in-Funktion. Direkter Anschluss (keine externe SPS notwendig).

Le encodeur simplifie le positionnement dans la direction Z. Est monté dans l'interrupteur fin de course rotatif. Teach-in fonction. Connexion directe (sans PLC externe).



Configuration / Konfiguration

Z (mm)

Z2 (mm)

PH (mm)

SL (mm)

A

+

B

+

C

+

D

+

E

+

F

+

G

+

H

Qty;

pc(s)



Option